

THORNTON

Thornton
Eletrônica Ltda

NEE-42/21/15

Parâmetros Efetivos do Núcleo:

| | | |
|--------------|---------|------------------|
| $\Sigma I/A$ | 0,54 | mm ⁻¹ |
| Le | 97,0 | mm |
| Ae | 181,0 | mm ² |
| Amin | - - - | mm ² |
| Ve | 17600,0 | mm ³ |

Peso Aprox. (pç) 44,0 g

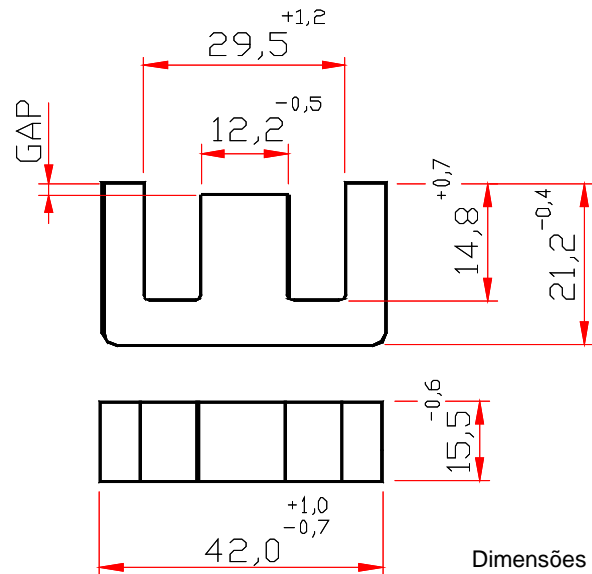

Dimensões em mm

COM GAP

| DESCRIÇÃO DE ENCOMENDA | MATERIAL | Al [nH] | Tol.% | ~g [mm] | ~ µe |
|---------------------------|----------|---------|-------|---------|------|
| NEE-42/21/15-85-IP12R | IP12R | 85 | ± 8 | *2,40 | 37 |
| NEE-42/21/15-90-IP6 | IP6 | 90 | ± 8 | *2,225 | 39 |
| NEE-42/21/15-100-IP12R | IP12R | 100 | ± 8 | *1,94 | 43 |
| NEE-42/21/15-100-IP6 | IP6 | 100 | ± 8 | *1,94 | 43 |
| NEE-42/21/15-110-IP6 | IP6 | 110 | ± 8 | *1,75 | 47 |
| NEE-42/21/15-110-IP12R | IP12R | 110 | ± 8 | *1,75 | 47 |
| NEE-42/21/15-142-IP6 | IP6 | 142 | ± 8 | 2,46 | 61 |
| NEE-42/21/15-142+/-5%-IP6 | IP6 | 142 | ± 5 | 2,46 | 61 |
| NEE-42/21/15-150-IP6 | IP6 | 150 | ± 8 | 2,30 | 64 |
| NEE-42/21/15-160-IP12R | IP12R | 160 | ± 8 | 2,11 | 69 |
| NEE-42/21/15-170-IP6 | IP6 | 170 | ± 8 | 1,95 | 73 |
| NEE-42/21/15-180-IP12R | IP12R | 180 | ± 8 | 1,81 | 77 |
| NEE-42/21/15-180-IP6 | IP6 | 180 | ± 8 | 1,81 | 77 |
| NEE-42/21/15-190-IP12R | IP12R | 190 | ± 10 | 1,7 | 81 |
| NEE-42/21/15-208-IP6 | IP6 | 208 | ± 10 | *0,75 | 89 |
| NEE-42/21/15-208-IP12R | IP12R | 208 | ± 10 | *0,75 | 89 |
| NEE-42/21/15-210-IP6 | IP6 | 210 | ± 10 | 1,48 | 90 |
| NEE-42/21/15-220-IP12R | IP12R | 220 | ± 10 | 1,32 | 95 |
| NEE-42/21/15-250-IP6 | IP6 | 250 | ± 10 | 1,18 | 107 |
| NEE-42/21/15-256-IP12R | IP12R | 256 | ± 10 | 1,15 | 110 |
| NEE-42/21/15-256-IP6 | IP6 | 256 | ± 10 | 1,15 | 110 |
| NEE-42/21/15-300-IP12R | IP12R | 300 | ± 10 | 0,94 | 128 |
| NEE-42/21/15-340-IP12R | IP12R | 340 | ± 20 | 0,80 | 146 |
| NEE-42/21/15-340-IP6 | IP6 | 340 | ± 20 | 0,80 | 146 |
| NEE-42/21/15-350-IP6 | IP6 | 350 | ± 10 | 0,76 | 150 |
| NEE-42/21/15-400-IP12R | IP12R | 400 | ± 10 | 0,64 | 172 |
| NEE-42/21/15-400-IP6 | IP6 | 400 | ± 10 | 0,64 | 172 |
| NEE-42/21/15-400+/-5%-IP6 | IP6 | 400 | ± 5 | 0,64 | 172 |
| NEE-42/21/15-460-IP6 | IP6 | 460 | ± 20 | 0,54 | 196 |
| NEE-42/21/15-500-IP6 | IP6 | 500 | ± 10 | 0,40 | 215 |
| NEE-42/21/15-800-IP12R | IP12R | 800 | ± 15 | 0,26 | 344 |
| NEE-42/21/15-800-IP6 | IP6 | 800 | ± 15 | 0,26 | 344 |

* gap Simétrico

Outros Al's mediante consulta

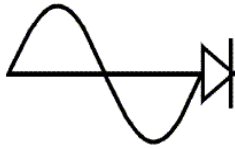

THORNTON

Thornton
Eletrônica Ltda

NEE-42/21/15

Parâmetros Efetivos do Núcleo:

| | | |
|--------------|---------|------------------|
| $\Sigma I/A$ | 0,54 | mm ⁻¹ |
| Le | 97,0 | mm |
| Ae | 181,0 | mm ² |
| Amin | - - - | mm ² |
| Ve | 17600,0 | mm ³ |

Peso Aprox. (pç) 44,0 g

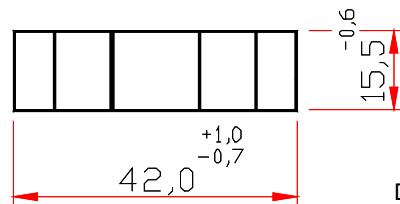
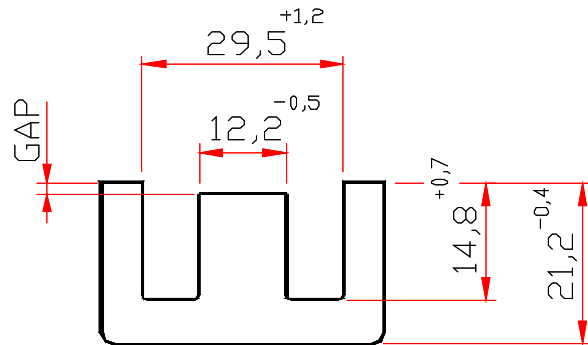

Dimensões em mm

SEM GAP

| DESCRIÇÃO DE ENCOMENDA | MATERIAL | Al [nH] | Tol.% | ~g [mm] | ~ µe |
|-------------------------|----------|---------|-------|---------|------|
| NEE-42/21/15-4000-IP12R | IP12R | 4000 | ± 25 | - - - | 1719 |
| NEE-42/21/15-4000-IP6 | IP6 | 4000 | ± 25 | - - - | 1719 |
| NEE-42/21/15-4100-IP12E | IP12E | 4100 | ± 25 | - - - | 1762 |

Outros Al's mediante consulta

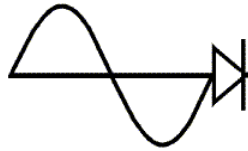

THORNTON

Thornton
Eletrônica Ltda

ACESSÓRIOS - NEE-42/21/15

CARRETEL

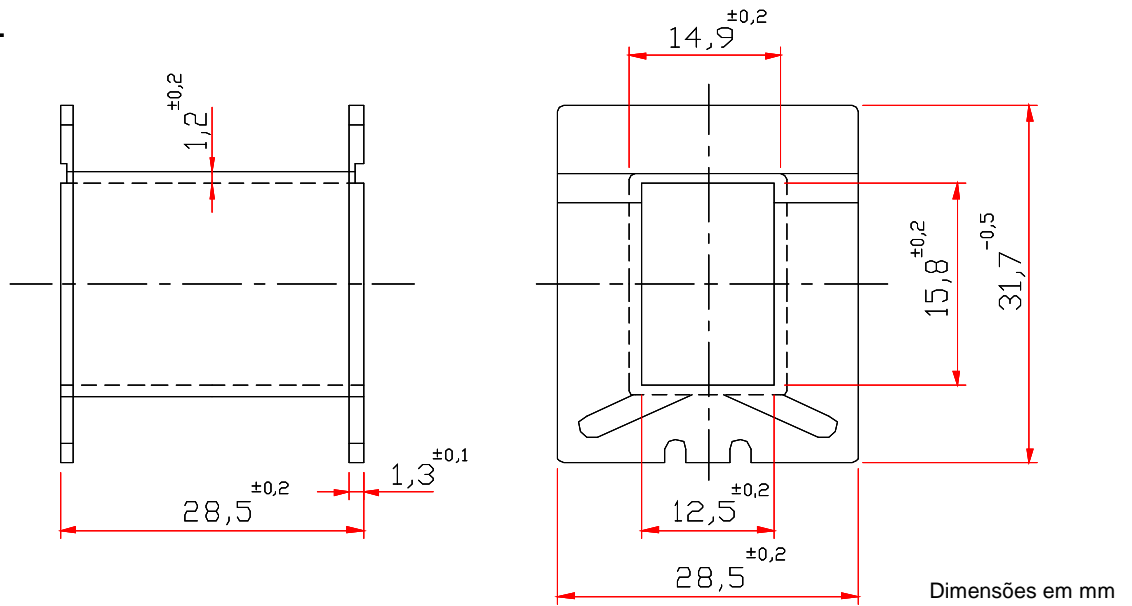

| DESCRIÇÃO DE ENCOMENDA | Nº DE SECÇÕES | JANELA [mm ²] | COMPRI. MÉD. [mm/esp] | PESO ~g [mm] | MATERIAL |
|------------------------|---------------|---------------------------|-----------------------|--------------|------------|
| CE-42/21/15-1/0-POM | 1 | 157,00 | 87,00 | 4,50 | Poliacetal |

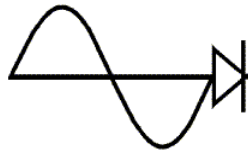

THORNTON

Thornton
Eletrônica Ltda

ACESSÓRIOS - NEE-42/21/15

CARRETEL 2

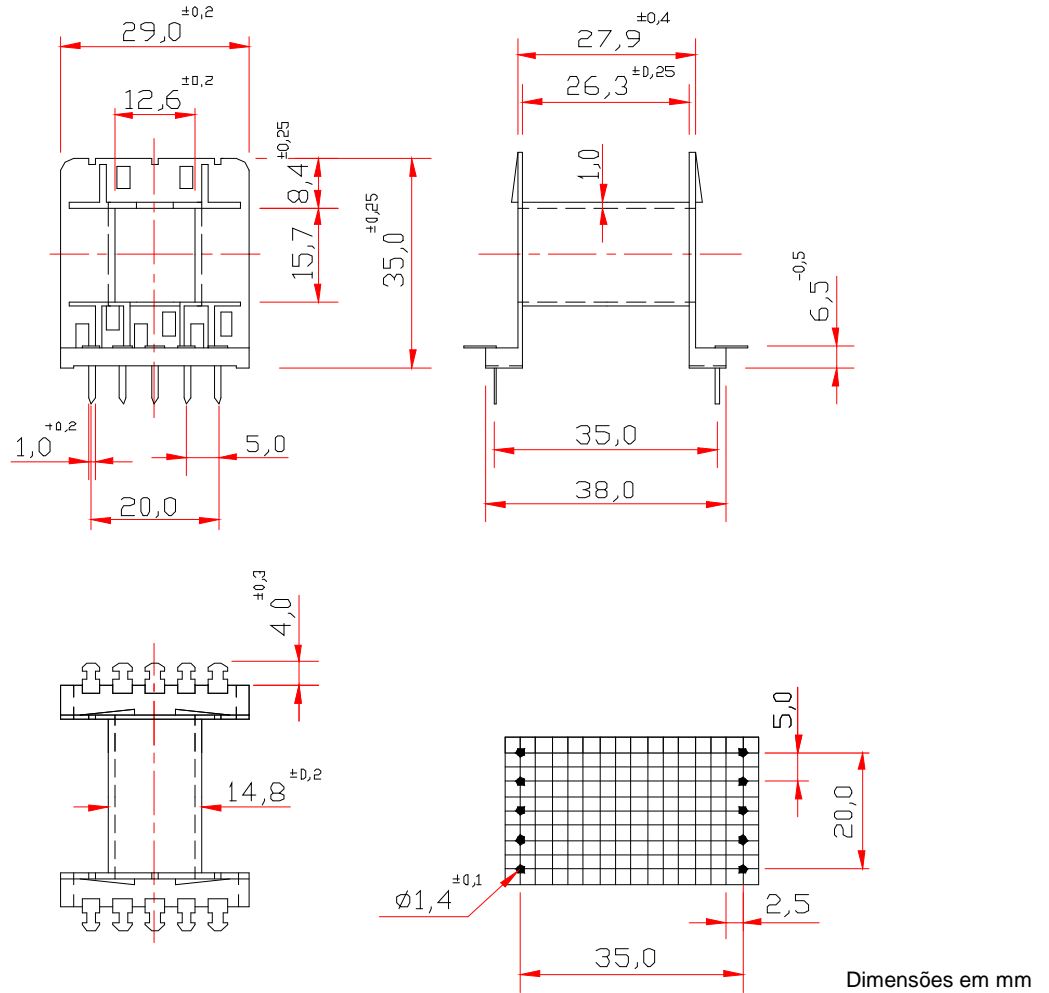

OBS: Máxima Temperatura de Soldagem por imersão: 400° por 2 seg.

| DESCRIÇÃO DE ENCOMENDA | Nº DE SECCÕES | JANELA [mm²] | COMPRI. MÉD. [mm/esp] | PESO ~g [mm] | MATERIAL |
|------------------------|---------------|--------------|-----------------------|--------------|--------------|
| CE-42/21/15-1/10-PAFV | 1 | 157,00 | 87,00 | 6,07 | Poliamida FV |

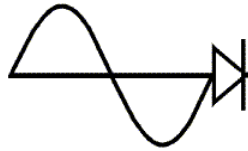

THORNTON

Thornton
Eletrônica Ltda

ACESSÓRIOS - NEE-42/21/15

CARRETEL 3

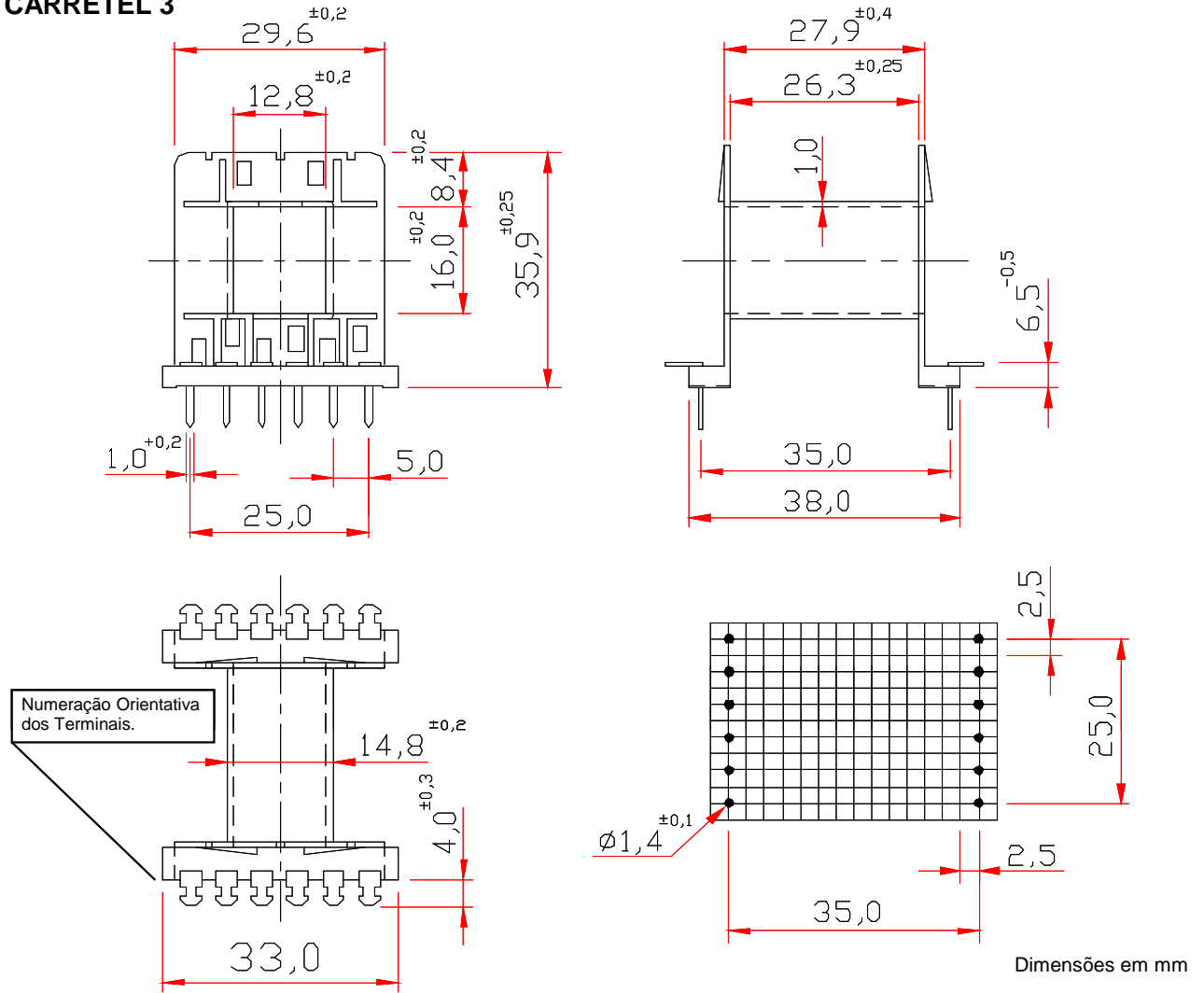

OBS: Máxima Temperatura de Soldagem por imersão: 400° por 2 seg.

| DESCRIÇÃO DE ENCOMENDA | Nº DE SECÇÕES | JANELA [mm ²] | COMPRI. MÉD. [mm/esp] | PESO ~g [mm] | MATERIAL |
|------------------------|---------------|---------------------------|-----------------------|--------------|--------------|
| CE-42/21/15-1/12-PAFV | 1 | 157,00 | 87,00 | 6,20 | Poliamida FV |

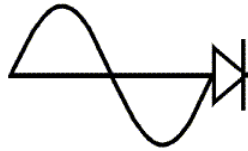

THORNTON

Thornton
Eletrônica Ltda

ACESSÓRIO - NEE-42/21/15

ABRAÇADEIRA

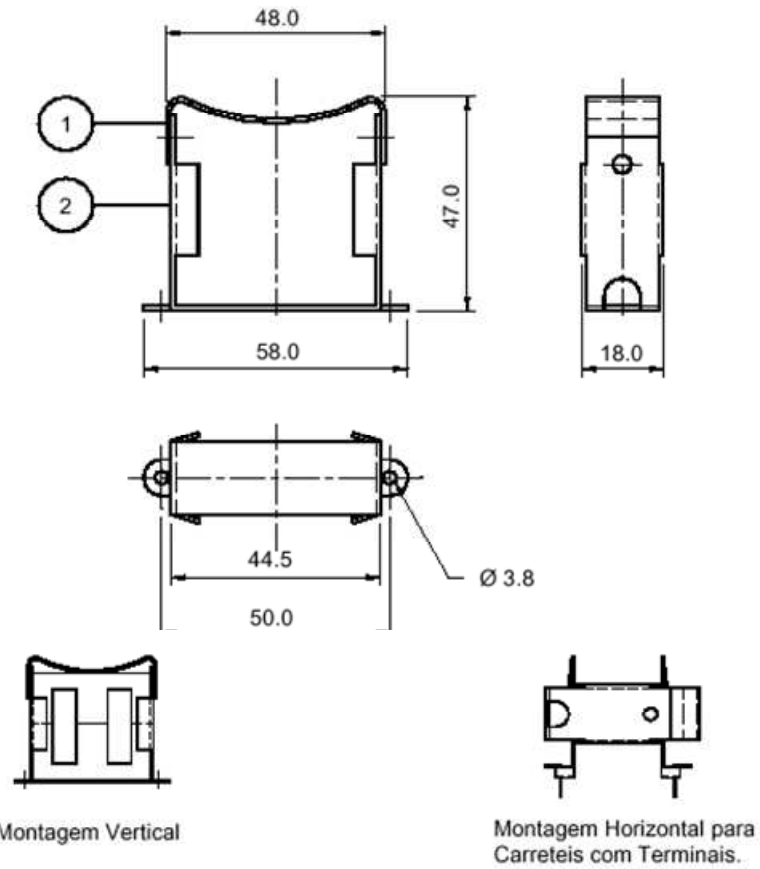

Dimensões em mm

| DESCRIÇÃO DE ENCOMENDA | FIG. | PESO ~g [mm] | MATERIAL |
|------------------------|-------|-----------------|----------------------------|
| M-NE-42/21/15-A | 1 | 4,50 | Mola - Aço Niquelado |
| A-NE-42/21/15-L | 2 | 14,50 | Abraçad. - Latão niquelado |
| AP-NE-42/21/15-L/A | conj. | 19,00 | - - - |