

THORNTON

Thornton
Eletrônica Ltda

NEE-28/10/11

Effective Core Parameters:

S I/A	0,573	mm ⁻¹
Le	49,29	mm
Ae	85,97	mm ²
Amin	- - -	mm ²
Ve	4238,23	mm ³

Weight Approx. (piece) 11,0 g

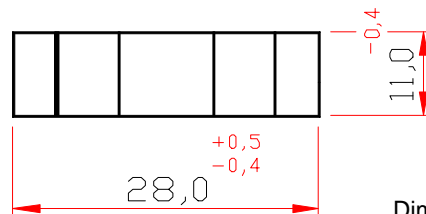
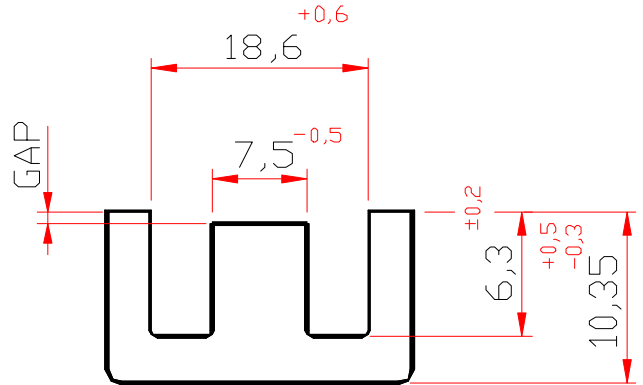

Dimensions in mm

WITH GAP

DESCRIPTION ORDER	MATERIAL	Al [nH]	Tol.%	~g [mm]	~ µe
NEE-28/10/11-75-IP12R	IP12R	75	±5	*1,00	34,2
NEE-28/10/11-100-IP12R	IP12R	100	±10	1,45	45,6
NEE-28/10/11-100-IP12E	IP12E	100	±10	1,45	45,6
NEE-28/10/11-120-IP12R	IP12R	120	±10	1,25	54,7
NEE-28/10/11-145-IP12R	IP12R	145	±10	0,90	66,1
NEE-28/10/11-145-IP12E	IP12E	145	±10	0,90	66,1
NEE-28/10/11-150-IP12R	IP12R	150	±10	0,83	68,4
NEE-28/10/11-170-IP12R	IP12R	170	±10	0,75	77,5
NEE-28/10/11-180-IP12R	IP12R	180	±10	0,65	82,0
NEE-28/10/11-188-IP12R	IP12R	188	±10	0,60	85,7
NEE-28/10/11-200-IP12R	IP12R	200	±10	0,56	91,2
NEE-28/10/11-250-IP12R	IP12R	250	±5	0,44	113,8
NEE-28/10/11-270-IP6	IP6	270	±15	0,35	123,0
NEE-28/10/11-270-IP12R	IP12R	270	±15	0,35	123
NEE-28/10/11-330-IP12R	IP12R	330	±10	0,30	150,4
NEE-28/10/11-450-IP12R	IP12R	450	±15	0,25	205

* Simetrical gap

WITHOUT GAP

DESCRIPTION ORDER	MATERIAL	Al [nH]	Tol.%	~g [mm]	~ µe
NEE-28/10/11-3300-IP12R	IP12R	3300	±25	- - -	1503,33
NEE-28/10/11-3300-IP12E	IP12E	3300	±25	- - -	1503,33
NEE-28/10/11-3300-IP6	IP6	3300	±25	- - -	1503,33

Others AL's by consulting