

THORNTON

Thornton
Eletrônica Ltda

NEE-20/10/5

Effective Core Parameters:

$\Sigma I/A$	1,38	mm ⁻¹
Le	43,0	mm
Ae	31,0	mm ²
Amin	25,5	mm ²
Ve	1340,0	mm ³

Weight Approx. (piece) 3,5 g

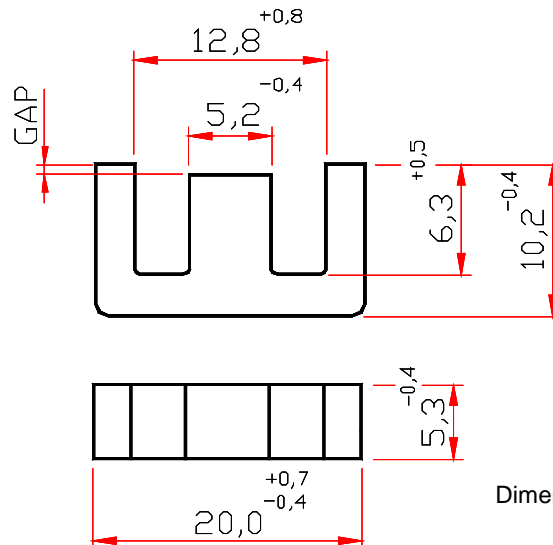

Dimensions in mm

WITH GAP

DESCRIPTION ORDER	MATERIAL	Al [nH]	Tol. %	~g [mm]	~ μe
NEE-20/10/5-40-IP6	IP6	40	± 8	*0,76	44
NEE-20/10/5-52-IP6	IP6	52	± 8	1,06	57
NEE-20/10/5-55-IP12R	IP12R	55	± 8	0,98	60
NEE-20/10/5-55-IP6	IP16	55	± 8	0,98	60
NEE-20/10/5-65-IP12R	IP12R	65	± 8	0,78	71
NEE-20/10/5-67-IP12R	IP12R	67	± 8	0,77	73
NEE-20/10/5-73-IP12R	IP12R	73	± 8	0,66	80
NEE-20/10/5-75-IP12R	IP12R	75	± 8	0,65	82,3
NEE-20/10/5-82-IP12R	IP12R	82	± 5	0,52	90
NEE-20/10/5-84-IP12R	IP12R	84	± 5	0,50	92
NEE-20/10/5-86-IP12R	IP12R	86	± 8	0,52	94
NEE-20/10/5-90-IP12R	IP12R	90	± 8	0,50	99
NEE-20/10/5-90-IP6	IP6	90	± 8	0,50	99
NEE-20/10/5-94-IP12R	IP12R	94	± 10	0,75	103
NEE-20/10/5-100-IP12R	IP12R	100	± 10	0,43	110
NEE-20/10/5-100-IP6	IP6	100	± 10	0,43	110
NEE-20/10/5-110-IP12E	IP12E	110	± 10	0,40	121
NEE-20/10/5-120-IP12R	IP12R	120	± 10	0,38	131,7
NEE-20/10/5-130-IP12R	IP12R	130	± 10	0,30	143
NEE-20/10/5-138-IP12R	IP12R	138	± 10	0,27	151
NEE-20/10/5-160-IP6	IP6	160	± 10	0,22	176
NEE-20/10/5-160-IP12R	IP12R	160	± 10	0,22	176
NEE-20/10/5-170-IP12R	IP12R	170	± 10	0,40	186
NEE-20/10/5-172-IP12R	IP12R	172	± 10	0,20	189
NEE-20/10/5-175-IP12R	IP12R	175	± 15	0,20	192
NEE-20/10/5-175-IP6	IP6	175	± 15	0,20	192
NEE-20/10/5-215-IP12R	IP12R	215	± 15	0,15	235
NEE-20/10/5-230-IP12R	IP12R	230	± 15	0,17	252
NEE-20/10/5-280-IP12R	IP12R	280	± 15	0,19	307
NEE-20/10/5-290-IP6	IP6	290	± 15	0,10	318

* Simetrical gap

WITHOUT GAP

DESCRIPTION ORDER	MATERIAL	Al [nH]	Tol. %	~g [mm]	~ μe
NEE-20/10/5-1300-IP12E	IP12E	1300	+30 / -20	---	1208
NEE-20/10/5-1300-IP12R	IP12R	1300	+30 / -20	---	1208
NEE-20/10/5-1300-IP6	IP6	1300	+30 / -20	---	1208
NEE-20/10/5-2500-TH50	TH50	2500	± 25	---	2745

Others AL's by consulting

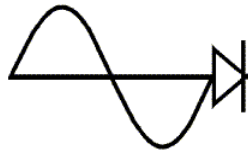

THORNTON

Thornton
Eletrônica Ltda

ACCESSORIES - NEE-20/10/5

COIL FORMER

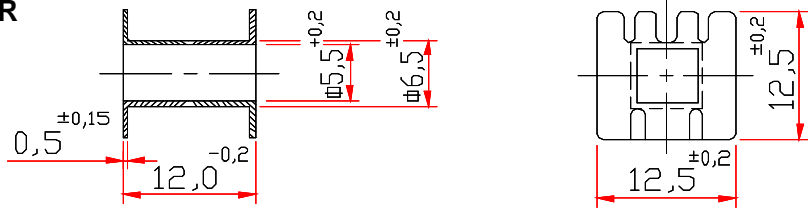

Fig. 1

Dimensions em mm

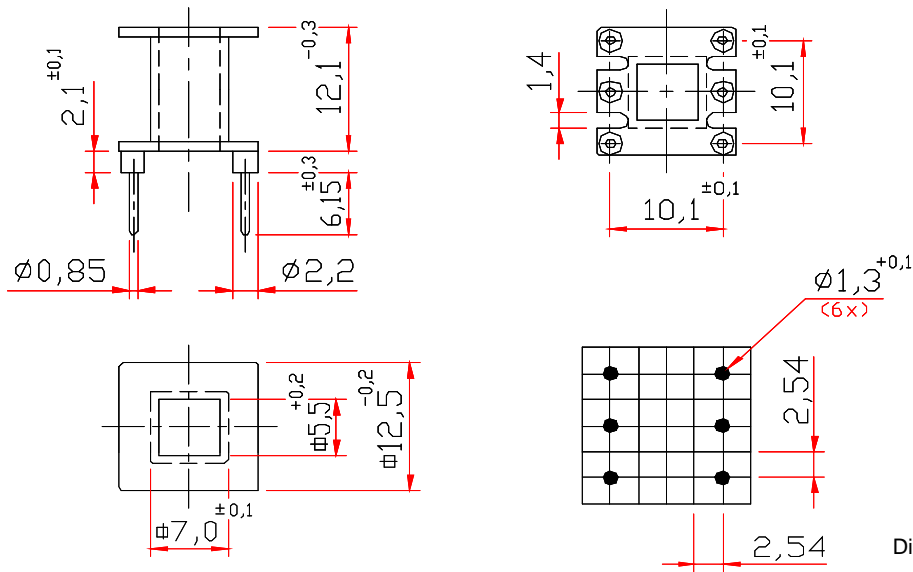
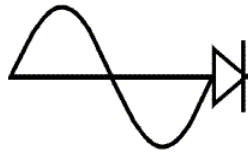

Fig. 2

Dimensions em mm

Maximum temperature for immersion soldering is 400° for 2 seconds

DESCRIPTION ORDER	FIG.	NUMBER OF SECTIONS	WINDOW [mm ²]	MEAN LENGTH [mm/turn]	WEIGHT ~ g [mm]	MATERIAL
CE-20/10/5-1/0-POM	1	1	26,00	38,00	0,50	Poliacetal
CE-20/10/5-1/6-BAQ	2	1 / 6T	25,00	30,00	0,85	Baquelite



THORNTON

Thornton
Eletrônica Ltda

ACCESSORIES - NEE-20/10/5

COIL FORMER

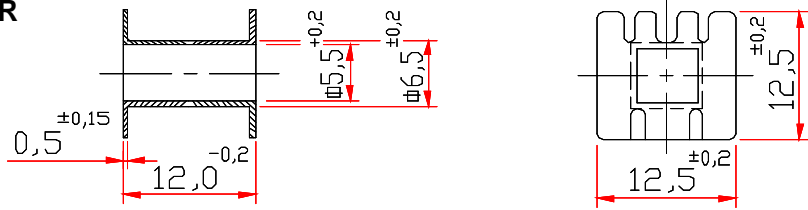

Fig. 1

Dimensions em mm

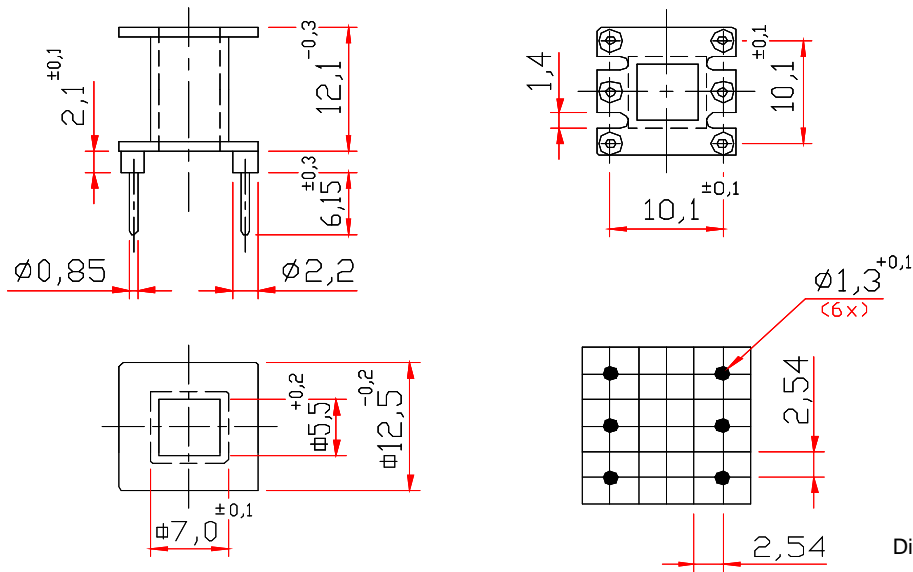

Fig. 2

Dimensions em mm

Maximum temperature for immersion soldering is 400° for 2 seconds

DESCRIPTION ORDER	FIG.	NUMBER OF SECTIONS	WINDOW [mm ²]	MEAN LENGTH [mm/turn]	WEIGHT ~ g [mm]	MATERIAL
CE-20/10/5-1/0-POM	1	1	26,00	38,00	0,50	Poliacetal
CE-20/10/5-1/6-BAQ	2	1 / 6T	25,00	30,00	0,85	Baquelite