

THORNTON

Thornton
Eletrônica Ltda

NEE-13/6/6

Effective Core Parameters:

$\Sigma I/A$	1.927	mm ⁻¹
Le	31.95	mm
Ae	16.238	mm ²
Amin	16.2	mm ²
Ve	529.8	mm ³

Weight Approx. (piece) 1,3 g

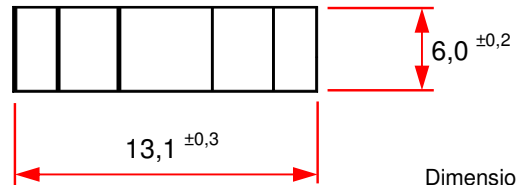
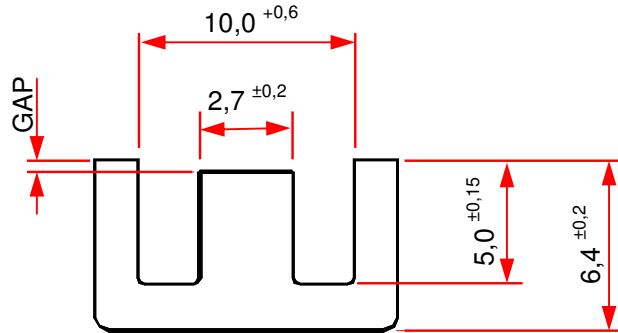

Dimensions in mm

WITH GAP

DESCRIPTION ORDER	MATERIAL	Al [nH]	Tol.%	~g [mm]	~ μe
NEE-13/6/6-55-IP12R	IP12R	55	±10	0,54	82
NEE-13/6/6-70-IP12R	IP12R	70	±10	0,50	104
NEE-13/6/6-82-IP12R	IP12R	82	±10	0,30	123

WITHOUT GAP

DESCRIPTION ORDER	MATERIAL	Al [nH]	Tol.%	~g [mm]	~ μe
NEE-13/6/6-900-IP6	IP6	900	+30 / -20	---	1353
NEE-13/6/6-900-IP12E	IP12E	900	+30 / -20	---	1353
NEE-13/6/6-900-IP12R	IP12R	900	+30 / -20	---	1353
NEE-13/6/6-1400-TH50	TH50	1400	+30 / -20	---	2105
NEE-13/6/6-1800-TH50	TH50	1800	min.	---	2706
NEE-13/6/6-2100-TH50	TH50	2100	+30 / -20	---	3157

Others AL's by consulting