

THORNTON

Thornton
Eletrônica Ltda

NC-25/20/13

Parâmetros Efetivos do Núcleo:

S I/A	0,86	mm ⁻¹
Le	86,0	mm
Ae	100,0	mm ²
Amin	- - -	mm ²
Ve	8600,0	mm ³

Peso Aprox. (pç) 23,0 g

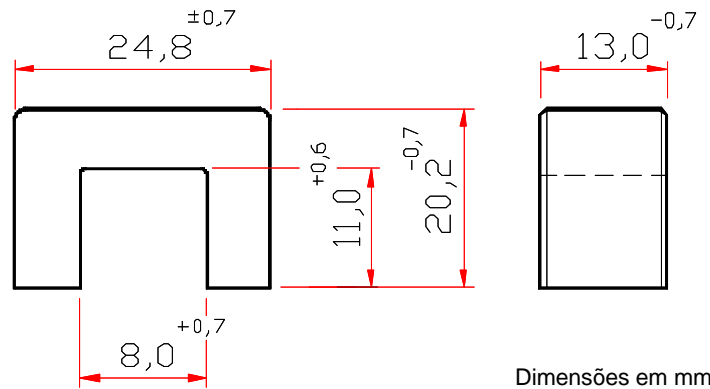

SEM GAP

DESCRIÇÃO DE ENCOMENDA	MATERIAL	Al [nH]	Tol.%	~g [mm]	~ µe
NC-25/20/13-2400-IP6	IP6	2400	+30 / -20	- - -	1642
NC-25/20/13-2600-IP12R	IP12R	2600	+30 / -20	- - -	1778

[Outros Al's mediante consulta](#)